

## Installation and operating instructions

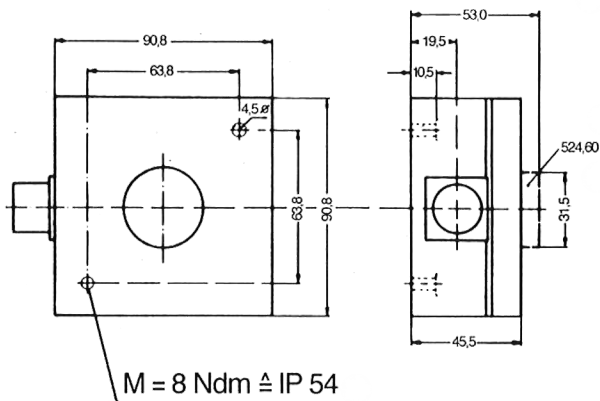

### 1. Application

This thermostat is for controlling heating or cooling in damp or dusty rooms e.g. garages, storerooms, toilets, stables, laundries etc.



### 2. Mounting

The control should be mounted on an inside wall approx 5' from floor level (1.6 m). Avoid draughts, direct heat from radiators, sunshine or heated walls (airing cupboards or chimney breasts).

For external mounting the north side of houses is preferred. If this is not possible the control must be shielded from direct sunlight, wind and rain.

### 3. Wiring diagram

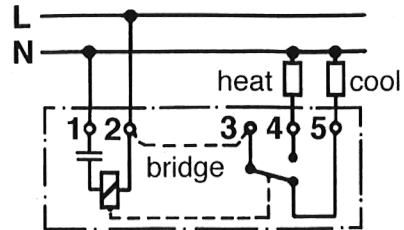

### 4. Technical Data

Order No.	Comp. No.	Temp. Range
<b>Controller with External Adjustment</b>		
AZT-A 524 510	0524 60 140 510	+ 5° to +35 °C
Operating voltage 50 Hz	220 V	
Tolerance	187... 242 V~	
Switching capacity	10 A/ 250 V~	
Switching load	2.5 KVA	
Contacts	1 c/o	
Ambient Temperature	-20 to +40 °C	
Switching differential	app. 0.5 K	
Housing class to DIN 40 050	IP 54	
Sensor	NTC Line arised	
Weight	app. 250 g	

### 5. Sealing the housing

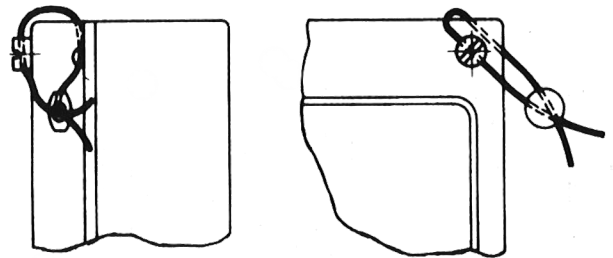

1. The top right hand cover screw can be replaced by a special screw with a longer head and with a hole drilled through its diameter (screw supplied separately).
2. Pass a thin wire through this hole and also the channel in the face of the lid and seal the two ends in the normal manner.

#### ATTENTION

The equipment may only be installed and/or mounted by an expert according to the existing safety regulations.

Possible applications and dimensioning particularly technical data may be found in our technical leaflets.